

# Multi-Protocol Converter

## Installation Instructions

Instructions d'installation  
Installationsanweisungen  
Instrucciones de instalación  
Istruzioni per l'installazione  
Installatie-instructies  
インストール手順  
安装指示



### ⚠ Must be installed by a qualified electrician in accordance with all national and local electrical and construction codes and regulations.

Doit être installé par un électricien qualifié conformément aux codes et réglementations électriques nationaux et locaux du bâtiment.

Muss von einem geprüften Elektriker in Übereinstimmung mit allen nationalen und örtlichen elektrischen Codes und Regelungen installiert werden.

La instalación debe realizarla un electricista calificado siguiendo todos los códigos y normativas eléctricas y de construcción, tanto nacionales como locales.

Devono essere installati da un elettricista qualificato in conformità con le norme locali e nazionali vigenti in materia di costruzioni edilizie e installazione di impianti elettrici.

Moet door een gekwalificeerd elektricien overeenkomstig alle nationale en lokale elektrische verordeningen worden geïnstalleerd.

国または地域の建築コードおよび規制にすべて従い、資格のある電気技師が設置してください。

必须根据所有国家和地方的电气和施工准则及规范，由符合资格的电工进行安装。

[www.colorkinetics.com/support](http://www.colorkinetics.com/support)

# 1

## Confirm all components received

Confirmez la réception de l'intégralité des composants

Bestätigen Sie, dass Sie alle Bestandteile erhalten haben

Compruebe si ha recibido todos los componentes

Confermare tutti i componenti ricevuti

Controleer alle ontvangen componenten

すべてのコンポーネントが揃っていることを確認します。

确认收到了所有部件

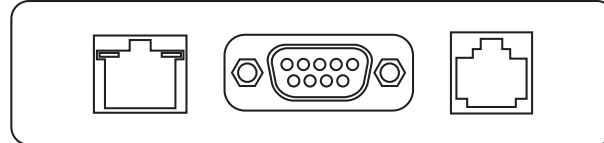
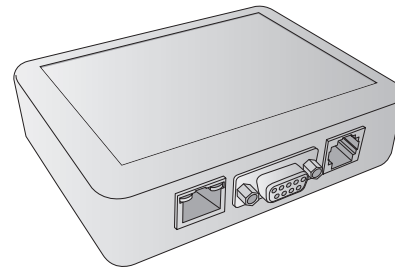

Ethernet

RS-232 Serial

DMX

# 2

## Mount (optional)

Montez (facultatif) Montieren (optional)

Montar (opcional) Montare (opzionale)

Monteer (optioneel) 取り付けます (オプション)

安装 (可选)

Mount vertically not horizontally

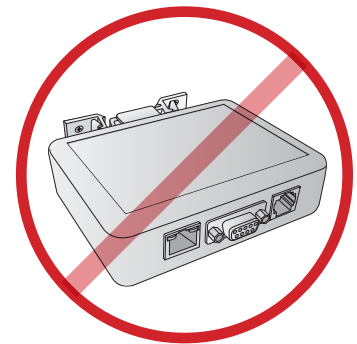
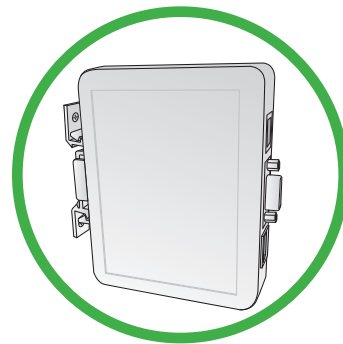
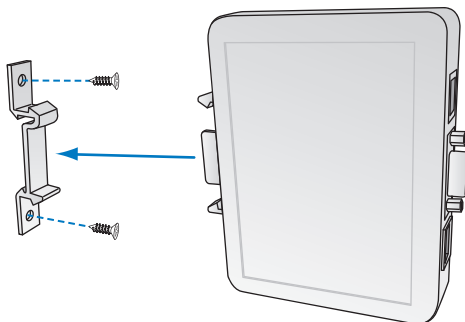

### 3

#### Connect

- Relier
- Verbinden
- Conectar
- Collegare
- Aansluiten
- 接続する
- 连

#### KiNET → DMX

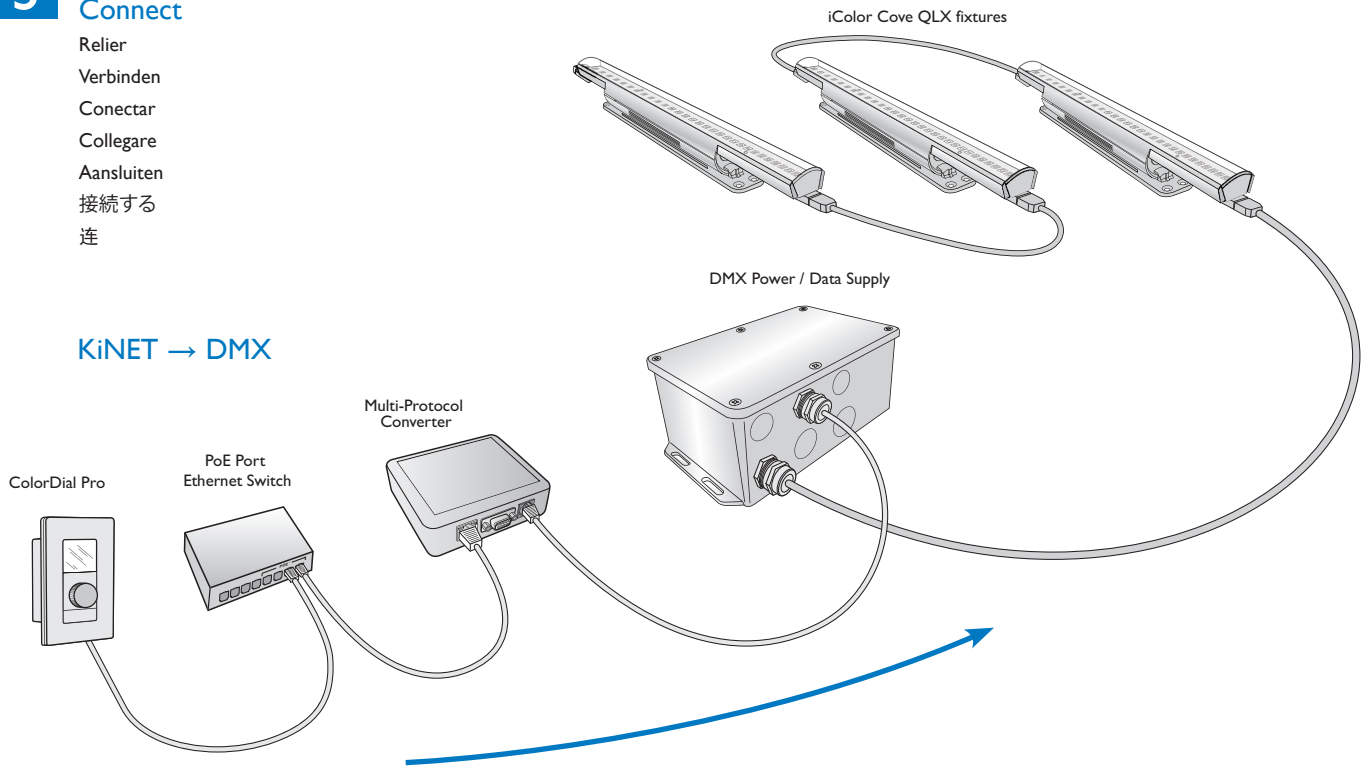

#### KiNET → DMX

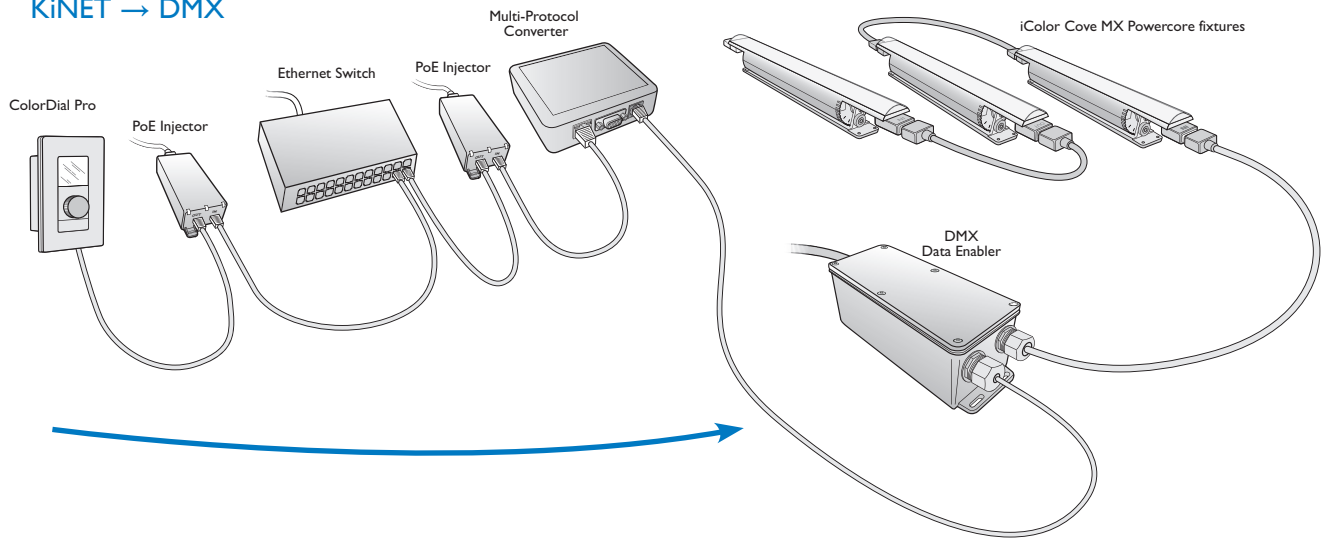

### 3 Connect

- Relier
- Verbinden
- Conectar
- Collegare
- Aansluiten
- 接続する
- 连

#### DMX → KiNET

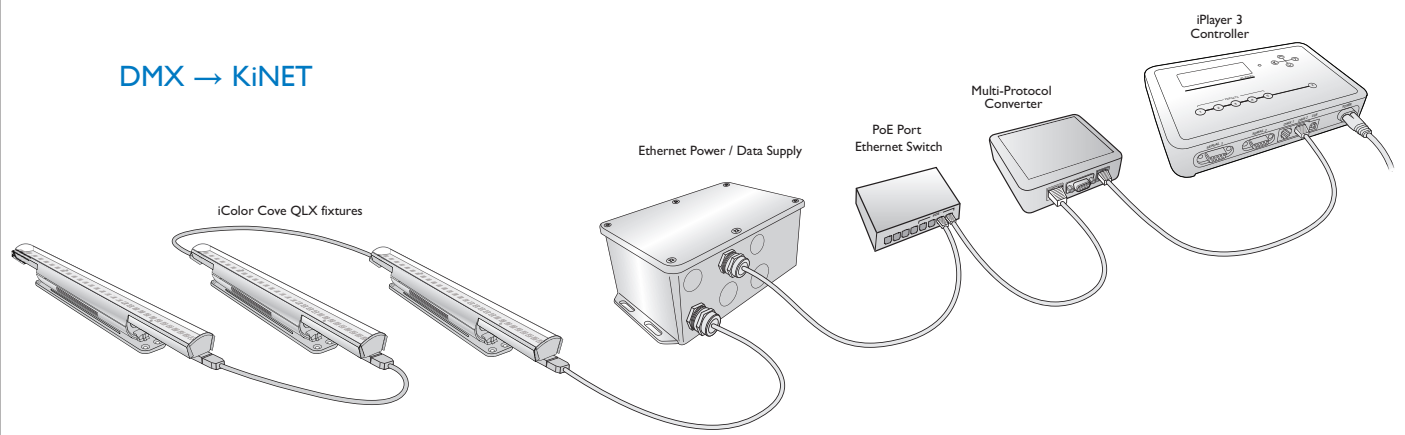

#### Third-Party Controller → RS-232 → ColorDial Pro

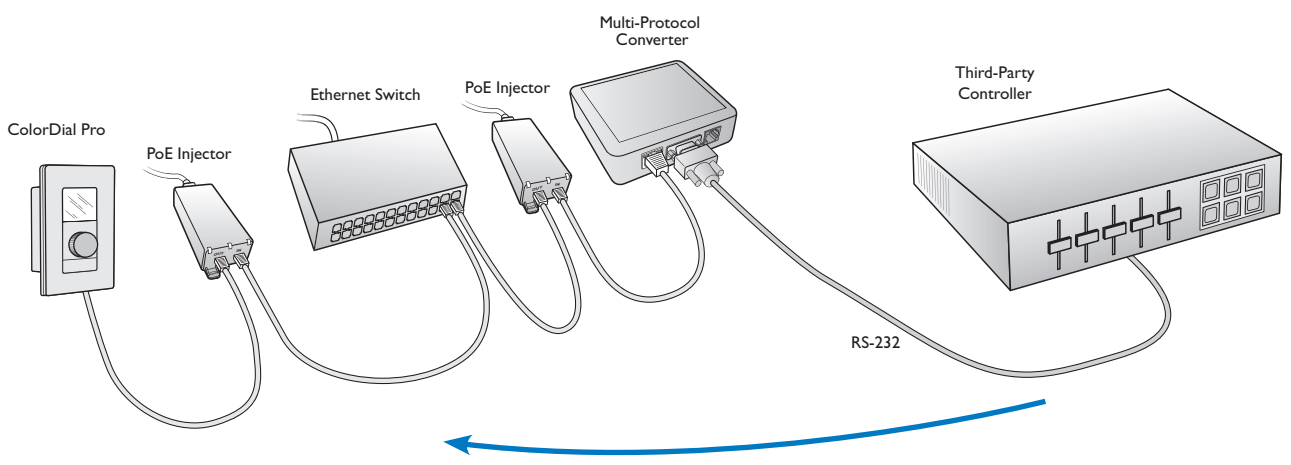

Item	Item Number	Part Number
Multi-Protocol Converter	104-000015-00	910503701414
Power over Ethernet Switch	120-000084-00	910503700789
Power over Ethernet Injector (North America)	109-000029-00	910503700383
Power over Ethernet Injector (Europe)	109-000029-01	910503700384

**⚠ Do not attempt to install or use until you read and understand the installation instructions and safety labels.**

Assurez-vous d'avoir lu et compris les instructions d'installation et les autocollants de sécurité avant l'installation ou l'utilisation.

Installieren oder verwenden Sie einen Beleuchtungskörper erst, nachdem Sie die Installationsanweisungen und Sicherheitsetiketten gelesen haben.

No intente instalar ni utilizar hasta haber leído y comprendido las instrucciones de instalación y las etiquetas de seguridad.

Non installare o utilizzare se non sono state lette e comprese le istruzioni per l'installazione e le etichette di sicurezza.

Voer geen poging uit tot installeren of gebruik totdat u de installatie-instructies en veiligheidslabels hebt gelezen en begrepen.

設置手順と安全ラベルの内容を読み、理解してから設置または使用を始めてください。

请先阅读并理解安装说明和安全标签，再进行安装或使用。

**⚠ Do not use if the product housing or power cables are damaged.**

N'utilisez pas l'appareil si le boîtier ou des câbles d'alimentation sont endommagés.

Nicht verwenden, wenn das Produktgehäuse oder die Netzkabel beschädigt sind.

No utilice el producto si la carcasa o los cables de alimentación están dañados.

Non utilizzare se l'alloggiamento del prodotto o i cavi di alimentazione sono danneggiati.

Niet gebruiken indien de behuizing of stroomkabels zijn beschadigd.

製品のハウジング、または電源ケーブルが損傷している場合は、使用しないでください。

如果产品的灯壳或电缆受损，切勿使用。

**⚠ Do not modify or alter the product. Doing so will void the warranty.**

Ne transformez pas et ne modifiez pas le produit. Toute modification annule la garantie.

Nehmen Sie keine Veränderungen an dem Produkt vor. Nichtbeachtung entwertet die Garantie.

No modifique ni altere el producto. Si lo hace, se anulará la garantía.

Non modificare né alterare il prodotto, in caso contrario la garanzia verrà invalidata.

Wijzig of verander niets aan het product. Hierdoor zal de garantie vervallen.

製品を改ざんしたり、変造したりしないでください。改ざんや変造を行うと、保証が無効になります。

切勿修改或更改产品。否则将使质保失效。

**⚠ This device complies with Part 15 of the FCC Rules. Operation is subject to the following two conditions: (1) this device may not cause harmful interference, and (2) this device must accept any interference received, including interference that may cause undesired operation.**

**⚠ This Class A digital apparatus complies with Canadian ICES-003. Cet appareil numérique de la classe A est conforme à la norme NMB-003 du Canada.**

**⚠ Warning - This is a class A product. In a domestic environment this product may cause radio frequency interference in which case the user may be required to take adequate measures.**

**⚠ 声明**  
此为A级产品，在生活环境中，该产品可能会造成无线电干扰。在这种情况下，可能需要用户对其它干扰采取切实可行的措施。

**⚠ Equipment to be used in a Network Environment 0 per IEC TR 62101. The Multi-Protocol Converter is to be connected only to PoE networks without routing to the outside plant.**



Philips Color Kinetics  
3 Burlington Woods Drive  
Burlington, Massachusetts 01803 USA  
Tel 888.385.5742  
Tel 617.423.9999  
Fax 617.423.9998  
www.philipscolorkinetics.com

Copyright © 2010 Philips Solid-State Lighting Solutions, Inc. All rights reserved.  
Chromacore, Chromasic, CK, the CK logo, Color Kinetics, the Color Kinetics logo, ColorBlast, ColorBlaze, ColorBurst, ColorGraze, ColorPlay, ColorReach, iW Reach, eW Reach, DIMand, EssentialWhite, eW, iColor, iColor Cove, IntelliWhite, iW, iPlayer, Optibin, and Powercore are either registered trademarks or trademarks of Philips Solid-State Lighting Solutions, Inc. in the United States and / or other countries. All other brand or product names are trademarks or registered trademarks of their respective owners. Due to continuous improvements and innovations, specifications may change without notice.